

PROGETTO PER 4 UNITA' ABITATIVE DI ALTO STANDING

LUGANO, VIA PRIVATA MARAINI

UEBERBAUUNG, 4-DUPLEXWOHNEINHEITEN LUXUSAUSFUEHRUNG.

DUPLEX C

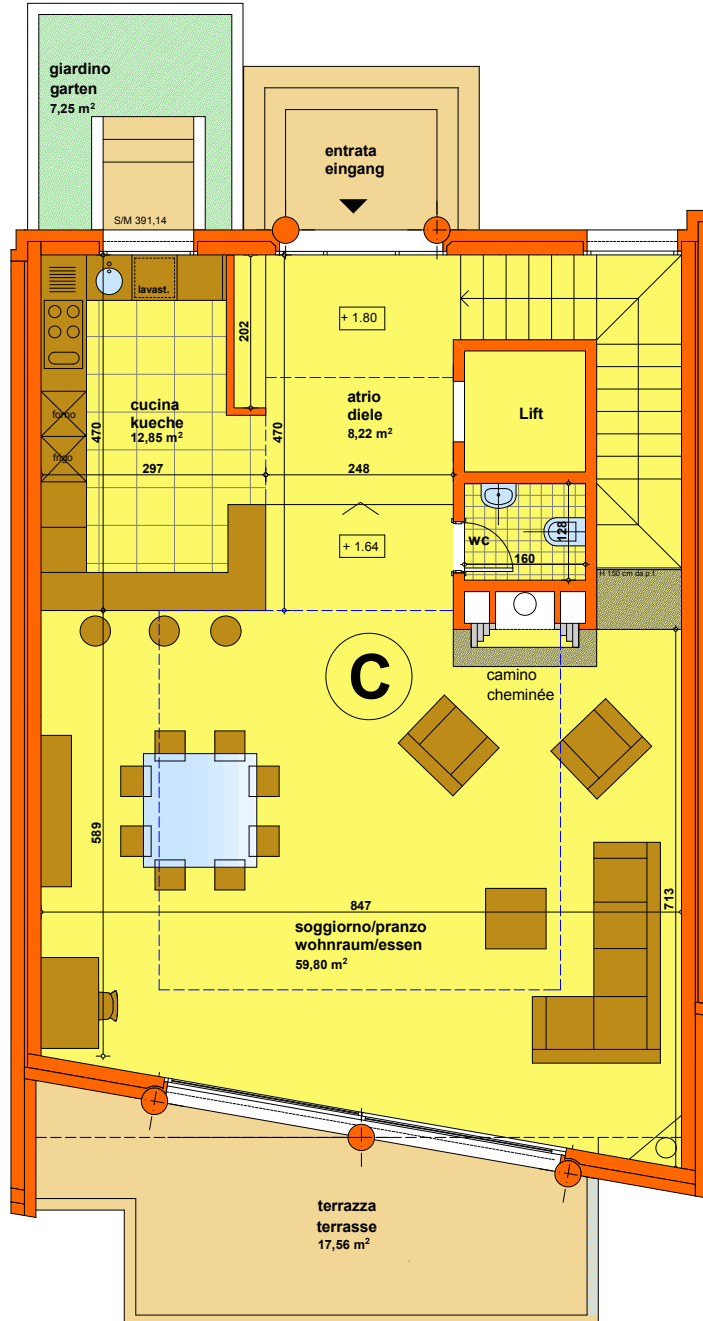

WOHNBEREICH - PIANO SOGGIORNI

1:100

m² 106,6 + terrazza - terrasse 17,56 m²

info:

ARCH. ADRIANO CANONICA V.PRADA 6942 SAVOSA
e-mail: architetto.adriano.canonica@gmail.com - tel. +4179 3541339